



Dow EnerBondSF Subfloor/Drywall Gun Foam

FEATURES



- Polyurethane adhesive for wall and floor construction
- Superior bonding power on both dry and damp surfaces
- One can is equal to 15 quart tubes of adhesive caulk
- Dispensing gun sold separately

Item No. 269944 (formerly Ener45)
EnerBondSF Gun Foam, 28 oz.

Dow EnerBondMH Subfloor/Drywall Gun Foam

FEATURES



- Polyurethane adhesive specifically designed for manufactured housing
- One can replaces up to 15 quart tubes of subfloor and drywall adhesive
- Dispensing gun sold separately

Item No. 269972 (formerly Ener47)
EnerBondMH Gun Foam, 28 oz.

Dow Froth-Pak 180 Kit



FROTH-PAK™ is a two-component spray applied polyurethane foam. Unlike one-component foam which uses moisture as a curing agent, FROTH-PAK is a chemically cured foam. This reduces curing time significantly. FROTH-PAK dispenses, expands and becomes tack free in seconds. FROTH-PAK will skin over in 30-40 seconds and be completely cured in under one minute.

FEATURES

- Yields: 200 board feet / 16.6 cubic feet
- Metal carrying handle and banding around tanks secure the kit for ease of use outside the box
- INSTA-FLO™ gun allows better foam dispensing control and precise monitoring
- Includes one Iso (A) cylinder; one Polyol (B) cylinder; 9 ft. gun hose assembly (GHA); six cone white spray (187918); 4 GG white spray (187915) and one petroleum jelly packet

Item No. 157804
Froth-Pak 180 Kit, 1.75 PCF

Dow Froth-Pak 600 Kits

FEATURES



- Yields: 600 board feet / 50 cubic feet
- INSTA-FLO™ gun allows better foam dispensing control and precise monitoring
- Includes one Iso (A) cylinder; one Polyol (B) cylinder; 15 ft. gun hose assembly (GHA); eight cone white spray (187918); 4 GG white spray (187915) and one petroleum jelly packet

Item No. 158099 A Cylinder for Froth-Pak 600 Kit, 1.75 PCF
Item No. 158098 B Cylinder for Froth-Pak 600 Kit, 1.75 PCF
Item No. 158398 15' Gun Hose Assembly for Froth-Pak 600 Kit

Dow Froth-Pak Refill System



The refill system consists of "A" and "B" chemical tanks, chemical filters, a high-pressure regulator and nitrogen lines, chemical dispensing hoses and the INSTA-FLO™ Gun. The refill system requires dry nitrogen for chemical tank pressurization. Nitrogen is not supplied with the FROTH-PAK system. Available in a variety of refill tank sizes: 17, 60, 120 and 350 gallons.

FEATURES

- Spray foam refill tanks for high-volume users of polyurethane foam
- Tank "A" (ISO) and tank "B" (POLYOL)
- Requires dry nitrogen for tank pressurization (not included)

There are many different combinations of parts available. Contact your Mid-Atlantic Fasteners Sales Rep for special quotations on the many items available to fit your application needs.





Pro 13 Foam Applicator Gun

FEATURES

- Provides precise control for filling, sealing and insulating gaps, cracks and window/door jambs
- Most economical, lightweight gun
- Good bead control, allows variable bead size
- Barbed dispenser tip
- Less foam waste
- No post-dispensing foam drip
- Restartable for up to 30 days

Item No. 230408 Pro 13 Foam Applicator Gun (formerly Ener13)

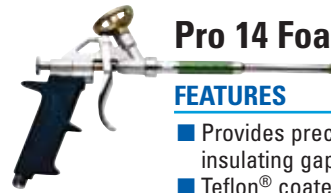

Pro 14 Foam Applicator Gun

FEATURES

- Provides precise control for filling, sealing and insulating gaps, cracks and window/door jambs
- Teflon® coated can adapter and needle
- Stainless steel check valve
- Good bead control, allows variable bead size
- Barbed dispenser tip
- Less foam waste
- No post-dispensing foam drip
- Restartable for up to 30 days

Item No. 230409 Pro 14 Foam Applicator Gun (formerly Ener14)

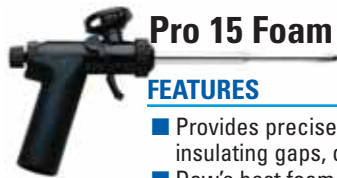

Pro 15 Foam Applicator Gun

FEATURES

- Provides precise control for filling, sealing and insulating gaps, cracks and window/door jambs
- Dow's best foam dispensing gun
- Teflon® coated can adapter, needle and check valve
- Stainless steel barrel
- Good bead control, allows variable bead size
- Barbed dispenser tip
- Less foam waste
- No post-dispensing foam drip
- Restartable for up to 30 days

Item No. 230410 Pro 15 Foam Applicator Gun (formerly Ener15)

One- and Two-Component Polyurethane Foam Sealant Systems for Roofs

Products:

FROTH-PAK™ Portable Spray Foam Kit
GREAT STUFF™ Pro Gaps & Cracks
ENERFOAM™

Application:

Use the FROTH-PAK portable spray foam kit to fill gaps and joints larger than 2". The spray forms an effective air sealant or insulation on most roofing materials. FROTH-PAK is also useful in sealing the ends of standing seam metal roofs.

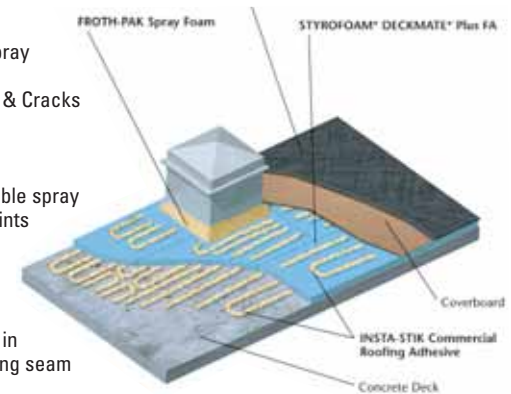

GREAT STUFF Pro Gaps & Cracks and ENERFOAM are ideal for sealing smaller areas, such as the joints between walls and ceilings and small gaps around pipe penetrations.

One- and Two-Component Polyurethane Foam Insulator, Sealant and Adhesive Systems for Walls

INSULATOR

Products:
GREAT STUFF™ Pro Spray Wall Foam
FROTH-PAK™ Portable Spray Foam Kit
ENERFOAM™

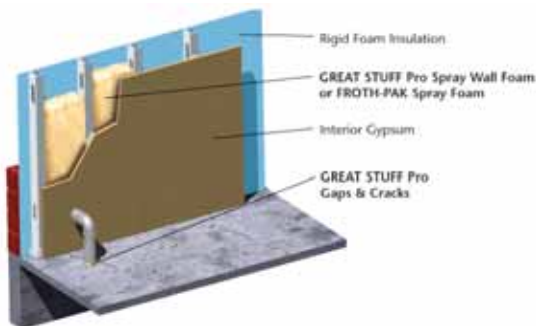

Application:

Insulate the wall cavity with GREAT STUFF Pro Spray Wall Foam or FROTH-PAK Spray Foam. Seal penetrations less than 2" with GREAT STUFF Pro Gaps & Cracks or ENERFOAM.

SEALANT

Products:
FROTH-PAK™ Portable Spray Foam Kit
GREAT STUFF™ Pro Gaps & Cracks
GREAT STUFF™ Pro Window & Door
ENERFOAM™



Application:

Insulate the wall cavity with GREAT STUFF Pro Spray Wall Foam or FROTH-PAK Spray Foam. GREAT STUFF Pro Gaps & Cracks and ENERFOAM are ideal for sealing smaller areas, such as the joints between walls and ceilings and small gaps around pipe penetrations.

GREAT STUFF Window & Doors fills gaps around window and door frames without causing distortion.

ADHESIVE

Products:
GREAT STUFF™ Pro Wall & Floor Construction Adhesive

Application:

Use GREAT STUFF Pro Wall & Floor Adhesive to secure sheathing, wall board or facings, including lumber, particleboard, plywood, rigid foam insulation, gypsum board and others. Apply a bead of adhesive to stud or masonry, then secure the sheathing, wall board or facing in place, followed by approved fasteners.

